

OWNER'S MANUAL

SERIE: "FALCON"

MODELS: F300 F330 F360
(F300H F330H F360H)*

2385.01-2020

COMPLETE SET:

Base version:	F300	F330	F360
Deluxe version:	F300L	F330L	F360L
Sport version:	F300S	F330S	F360S
Tender Deluxe version:	F300T	F330T	F360T

H* – boat tube is made of HYPALON (Du Pont registered trademark) coated fabrics.

CONTENTS:

DANGER LEVELS	3
INTRODUCTION	3
IDENTIFICATION PLATE	4
SAFETY REGULATIONS	5
BEAUFORT Wind Scale and Corresponding State of the Sea, After Few Hours of Wind, Away From the Coast.	6
Boat Design Categories	6
REMEMBER FIRE DANGER ALWAYS	7
TECHNICAL SPECIFICATIONS	8
COMPLETE SET	10
GENERAL VIEW of the BOATS	11
STEERING CONSOLE	
Steering Console for DeLuxe and Tender Deluxe Versions	15
Tender Container for DeLuxe and Tender Deluxe Versions	16
Steering Console for Sport Version	17
Inflation/deflation boat tube	18
PREPARATION FOR EXPLOITATION	19
DRAIN SYSTEM	19
REMOVABLE FUEL TANK	20
MAINTENANCE	21
OPERATING REGULATIONS	21
REBOARDING MEANS	26
WARNING SIGNS AND LABELS (ABYC standards)	27

CE Certification and Main Features



The CE marking indicates that the inflatable boat meets the requirements of the Recreational Craft Directive 2013/53/EU

Certifying Body:
INTERNATIONAL MARINE
CERTIFICATION INSTITUTE
Rue Abbe Cuypers 3
B-1040 Bruxelles / Belgique
Notified Body : 0609
www.imci.org

**Name of
Manufacturer:**
BRIG Ltd.
Lozovskaya 88,
Dergachy 62303
Kharkovskaya obl.
UKRAINE
www.brigboats.com

DANGER LEVELS.

The manual contains warnings, identified as follows:

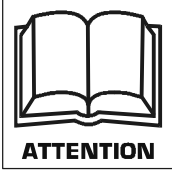
	<p>A note like this indicates that there is serious risk that is likely to cause death or permanent serious injury, if appropriate precautions are not taken.</p>
	<p>A note like this indicates the existence of risk that may cause death or injury, if appropriate precautions are not taken.</p>
	<p>A note like this indicates reference to the application of safety or environmental protection practices, or draws attention to unsafe behaviour that might cause injury to persons or damage to the craft, its components or the environment.</p>

INTRODUCTION.

This manual was written to help you using your boat safely. It contains information of the boat, its equipments (supplied or installed), operation and maintenance.

	<p>Before using your boat, read the MANUAL carefully and ensure that you have understood all the procedures it describes. Before taking command of your boat, be sure to have acquired experience and confidence in its operation.</p>
--	--

IDENTIFICATION PLATE.

Builder's Plate:
Builder's Plate:

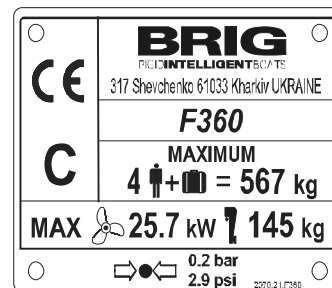
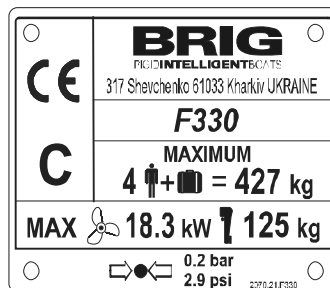
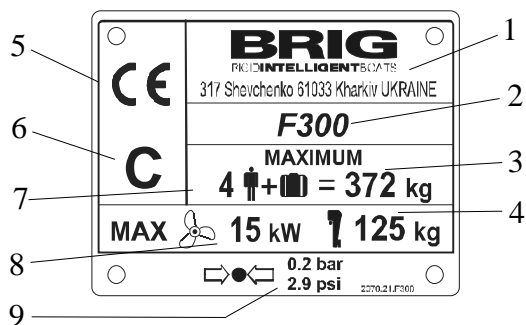

- 1 - Manufacturer's name and contact address of the manufacturer
- 2 - Model name
- 3 - Maximum load for the builder's plate - including mass of the persons and cargo onboard, mass of the contents of the removable fuel tank when full, but excluding mass of the max motor
- 4 - Maximum mass of the outboard including controls and batteries
- 5 - CE mark
- 6 - Design Categories according to Directive 2013/53/EU
- 7 - Maximum recommended persons' capacity (75 kg each)
- 8 - Maximum outboard(s) power rating (in kW)
- 9 - Nominal pressure for each inflatable buoyancy chambers

Plate with identification number:

UA-QRK12345A000

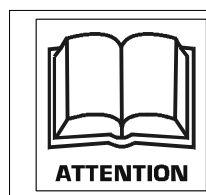



It is fundamental for the plates to be aboard the boat, since they are only form of recognition and identification. Without them the boat does not comply with the legislation in effect. The plates must never be removed. Any tampering or removal not authorised by the manufacturer is the full responsibility of the owner.

SAFETY REGULATIONS.

This manual contains recommendations and basic rules of conduct for using the boat in complete safety. Although it is not possible to offer safety information for all potential situations, in general it is recommended that you:

	Regularly check which safety requirements are in force.
	Maintain the boat and the onboard plants in optimum condition.
	Have the boat inspected by the dealer where it was purchased or by an authorised machanic at least once every year for your own safety and for maintaining the guaruntee.

	Always check weather and seagoing conditions before setting out. For safe navigation, compare the design category of your boat with the table below.
	When the tank is installed by the yard, the plant is prepared with a graund plait. The installation of the motor MUST FORESEE A PLAINT CONNECTION to the boat graund plait. Failure to connect (or failed maintenance) can result in the tank perforaiting leading to a serious risk of fire / explosion caused by leaking fuel.

	<p>Max number of transportable persones is referred to an established weight of 75 kg per person (ISO 6185), so always make reference to total maximum transportable waight.</p> <p>The max weight of the installable motors indicates the maximum overall weight applicable on the stern board, including any emergency motors. NEVER exceed the stated value.</p>
---	--

BEAUFORT Wind Scale and Corresponding State of the Sea, After Few Hours of Wind, Away From the Coast.

Force	Denomination	Knots	Km/h	m/sec	State of the sea and wave height in meters	
0	Calm	<1	<1	0-0.2	Calm	0
1	Light Air	1-3	1-5	0.3-1.5	Calm	0
2	Light Breeze	4-6	6-11	1.6-3.3	Almost calm	0.2
3	Gentle Breez	7-10	12-19	3.4-5.4	Almost calm	0.2
4	Moderate Breeze	11-16	20-28	5.5-7.9	Small waves	0.5
5	Strong Breeze	17-21	29-38	8.0-10.7	Large waves	1.25
6	Fresh Wind	22-27	39-49	10.8-13.8	Large waves	2.0
7	Strong Wind	28-33	50-61	13.9-17.1	Very large waves	2.5
8	Gale	34-40	62-74	17.2-20.7	Rough sea	4
9	Strong Gale	41-47	75-88	20.8-24.4	Very rough sea	6
10	Storm	48-55	89-102	24.5-28.4	Heavy	9
11	Violent Storm	56-63	103-117	28.5-32.6	Very heavy	14
12	Hurricane	64 and over	118 and over	32.7and over	Stormy	14 and over

Boat Design Categories (Directive 2013/53/EU):

Design category	Wind force (Beaufort scale)	Significant wave height
"A" - "Ocean"	exceeding 8	exceeding 4
"B"- "Offshore"	up to,and including, 8	up to,and including, 4
"C"- "Inshore"	up to,and including, 6	up to,and including, 2
"D"- "Sheltered waters"	up to,and including, 4	up to,and including, 0.3

NOTE: **The significant wave height** is the mean height of the highest one-third of the waves, which approximately corresponds to the wave height estimated by an experienced observed. Some waves will be double this height.

REMEMBER FIRE DANGER ALWAYS.

Fire may be caused by:

Crew negligence when smoking, the presence aboard of flammable liquids, electrical contacts, propulsion motor, errors in fueling, or if maintenance has not been performed as required.

Once again, it is important that the crew behave correctly and that the boat is kept in order to avoid serious damage to it and to persons.

	Easy flammable products must not be kept aboard.
---	--

	BATTERY: the battery may cause sparks or explosions. It must be stored in an appropriate container, easily reached and well aired, AWAY FROM FUEL OR INFLAMMABLE PRODUCTS . Periodically check that the clips are tight and protect them with appropriate insulation in order to prevent sparks or the spread of current.
---	---

However, if a fire does occur aboard, stop motor, disconnect the batteries immediately, check to see if it is an electrical component or any case a small-scale fire that does not involve flammable liquids, in which case use a suitable fire extinguisher to try and put the fire out completely.

	Extinguisher or any other fire-fighting equipment must not be kept in compartments with key lock, but in easily accessible and clearly indicated locations.
	Extinguisher or any other fire-fighting equipment should be checked periodically and replaced with the same or superior types if expired or inefficient .

	Equip the boat with fire-fighting equipment before launch and use.
---	--

TECHNICAL SPECIFICATIONS.

The basic parameters and dimensions of the boats F300, F330, F360 comply with the data specified in the following table. All dimensions measurements indicated have a tolerance of +/- 3%, weight measurements indicated have a tolerance of +/- 5%.

	F300	F300L	F300S	F330	F330L	F330S	F360	F360L	F360S
Length (without engine), m			3.00			3.30			3.60
Beam, m			1.64			1.64			1.70
Height, m	0.70	0.85	0.95	0.70	0.85	0.95	0.78	0.78	0.95
Inflatable tube diameter, m			0.40			0.40			0.45
Cockpit dimensions: - length, m			2.00			2.20			2.45
- width, m			0.84			0.84			0.80
Number of independent air-tight chambers			3			3			3
Nominal pressure, BAR(psi)			0.2 (2.9)			0.2 (2.9)			0.2 (2.9)
Passengers capacity (75kg each), persons			4			4			4 (5**)
Recommended engine power			15-20hp			15-20hp			20-30hp
Maximum engine power			20hp / 15kW			25HP / 18.3kW			35HP / 25.7kW
Maximum engine weight (including controls and battery), kg			125			125			145
Engine shaft length			short / 15"			short / 15"			short / 15"
Weight of empty boat (without equipment), kg			65			75			90
Weight of boat with equipment (with console and seat without engine), kg	--	87	92	--	97	102	--	112	117
Maximum load capacity (ISO method), kg			515			570			730
Displacement in Light Craft Condition (LCC), kg			235			245			280
Maximum total load (ML), kg			372			427			567
Maximum transportable mass, kg			307			372			520
Maximum load for the builder's plate*, kg			372*			427*			567*
Loaded displacement mass(LDC),kg			607			672			847
Design category			C			C			C

*Maximum load for the builder's plate - including mass of the persons and cargo onboard, mass of the contents of the removable fuel tank when full, but excluding mass of the max motor.

** For the American market only

			F300T	F330T	F360T
Length (without engine)	m		2.90	3.14	3.50
Beam	m		1.64	1.64	1.70
Height	m		0.85	0.85	0.78
Inflatable tube diameter	m		0.40	0.40	0.45
Cockpit dimensions:					
- length	m		2.00	2.20	2.45
- width	m		0.84	0.84	0.80
Number of independent air-tight chambers			3	3	3
Nominal pressure	BAR(psi)		0.15 (2.2)	0.15 (2.2)	0.15 (2.2)
Passengers capacity (75kg each)	persons		4	4	4 (5**)
Recommended engine power			15-20hp	15-20hp	20-30hp
Maximum engine power*			20HP / 15kW	25HP / 18.3kW	35HP / 25.7kW
Maximum engine weight					
(including controls and battery)	kg		125	125	145
Engine shaft length			short / 15"	short / 15"	short / 15"
Weight of empty boat (without equipments)	kg		70	85	100
Weight of boat with equipments (with console and seat without engine)	kg		92	107	122
Maximum load capacity (ISO method)	kg		515	570	730
Displacement in Light Craft Condition (LCC)	kg		235	245	280
Maximum total load (ML)	kg		372	432	572
Maximum transportable mass	kg		307	377	477
Maximum load for the builder's plate*	kg		372*	432*	572*
Loaded displacement mass(LDC)	kg		607	677	852
Design category			C	C	C

*Maximum load for the builder's plate - including mass of the persons and cargo onboard, mass of the contents of the removable fuel tank when full, but excluding mass of the max motor.

** For the American market only

COMPLETE SET for Base, Deluxe, Sport and Tender Deluxe versions.

In the table shows the maximum possible complete set, which may differ from your boat.

	Base version	Deluxe version	Sport version	Tender Deluxe version
Inflatable boat	+	+	+	+
Front step-plate with navigation lights	–	–	–	+
Hard tube ends	–	–	–	+
Front removable cushion (excluding F300)	–	+	+	+
"SPORT" console	–	–	+	+
Deluxe Console	–	+	–	+
Steering wheel, steering system with cable	–	+	+	+
Soft seat (Tender Container)	–	+	–	+
Wooden seat	+	–	–	–
Overall cover	+	+	+	+
Overall cover for "SPORT" console	–	–	+	–
Suntop (excluding F300)	+	+	+	+
Bow stowage bag	+	+	+	+
Underseat stowage bag for wooden seat	+	–	–	–
SeaDek set	+	+	+	+
Foot pump	+	+	+	+
Paddles	+	+	+	+
Set of spare parts and repair kit	+	+	+	+
Kit bag	+	+	+	+
Owner's manual	+	+	+	+

Note. Perfection of the design and improvement of quality of our products is the fundamental production policy of our company. Therefore, alternations may be made to the complete set (and as the components become available).

GENERAL VIEW of the BOATS.

Boat General View (see Fig. 1).

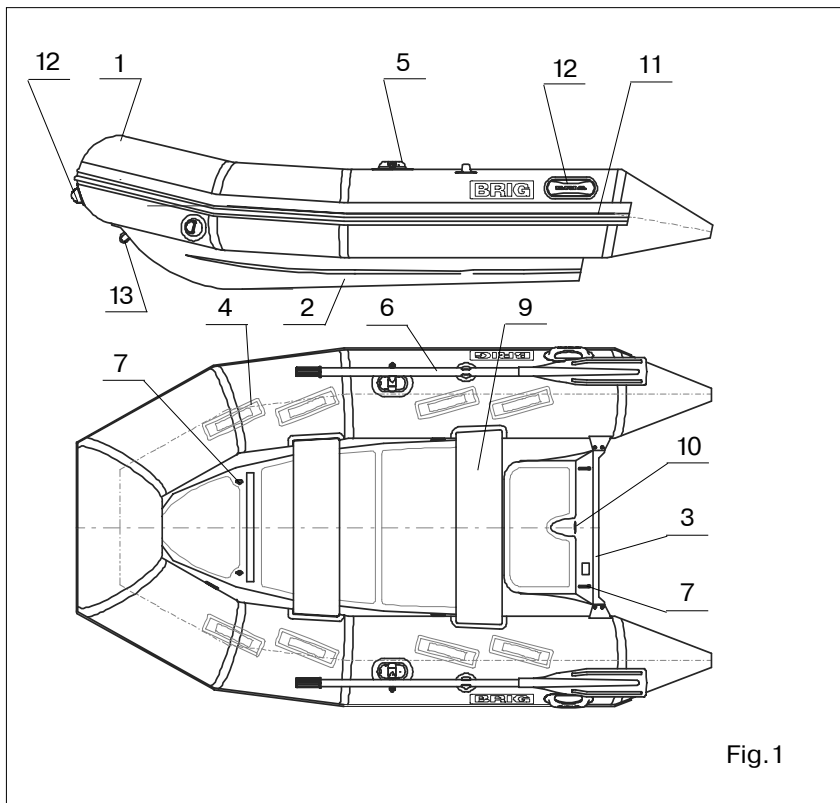

- 1 - Inflatable tube with Inflation valve
- 2 - Rigid bottom
- 3 - Transom with engine mounting plate
- 4 - Hangles
- 5 - Oarlock
- 6 - Oars and oars holder
- 7 - Bow lifting eyes
- 8 - Rear lifting eyes
- 9 - Wooden seats
- 10 - Drain valve
- 11 - Rubbing strake
- 12 - Carrying handle
- 13 - Towing bow eyes

DELUXE version Boat General View (see Fig.2).

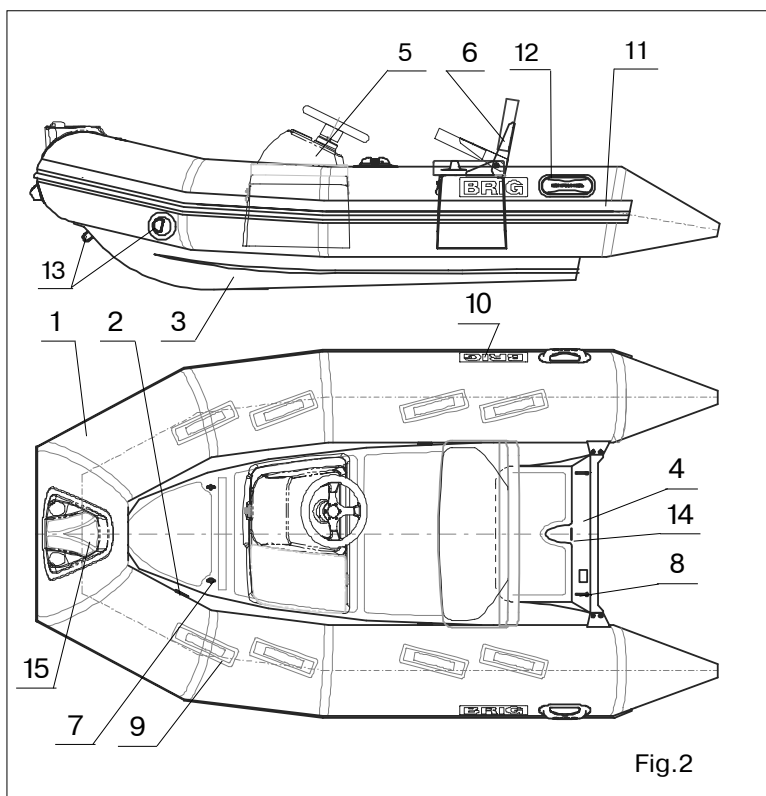

- 1 - Inflatable tube
- 2 - Inflation valves
- 3 - Rigid bottom with transom
- 4 - Outboard engine mountingplate
- 5 - Tender luxe console
- 6 - Tender container
- 7 - Bow lifting eyes
- 8 - Rear lifting eyes
- 9 - Handles
- 10 - "BRIG" label
- 11 - Rubbing strake
- 12 - Carrying handles
- 13 - Towing bow eye
- 14 - Drain valve
- 15 - Bow plate with navigations lights

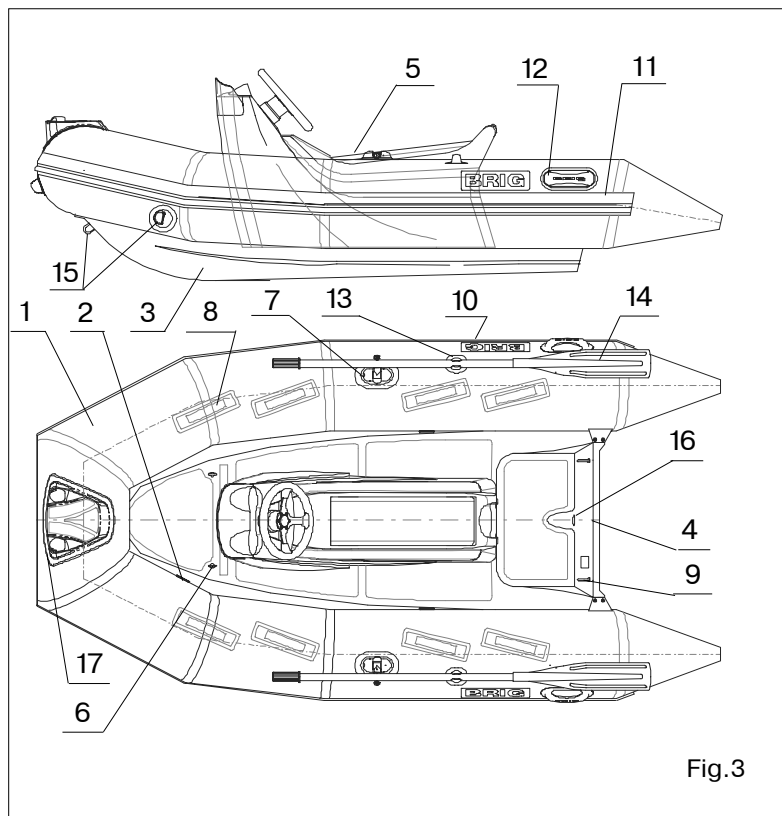

SPORT version Boat General View (see Fig.3).

- 1 - Inflatable tube
- 2 - Inflation valves
- 3 - Rigid bottom with transom
- 4 - Outboard engine mountingplate
- 5 - Sport console
- 6 - Bow lifting eyes
- 7 - Rowlock
- 8 - Handles
- 9 - Rear lifting eyes
- 10 - "BRIG" label
- 11 - Rubbing strake
- 12 - Carrying handle
- 13 - Oar stowage
- 14 - Oar
- 15 - Towing bow eye
- 16 - Drain valve
- 17 - Bow plate with navigations lights

Fig.3

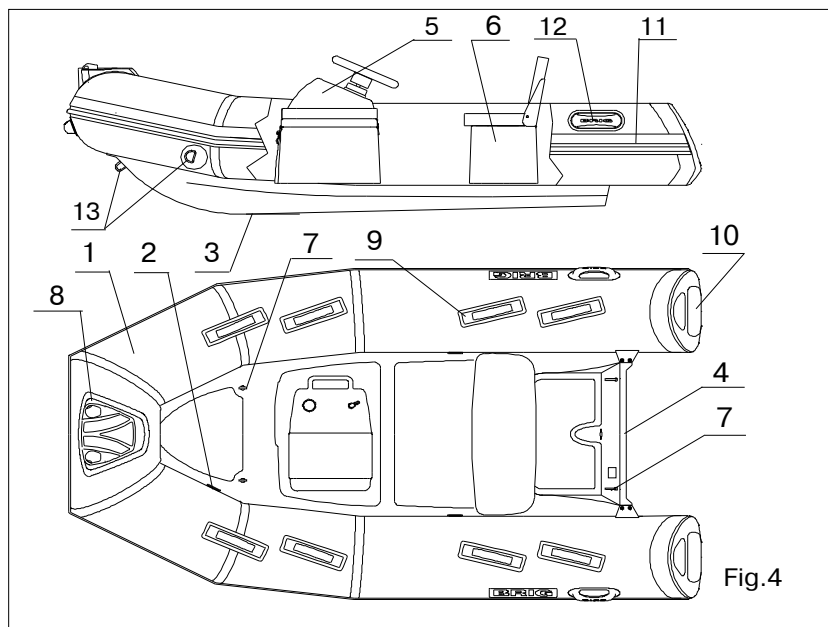

TENDER DELUXE version Boat General View (see Fig.4).

- 1 - Inflatable tube
- 2 - Inflation valves
- 3 - Rigid bottom with transom
- 4 - Outboard engine mounting plate
- 5 - Tender luxe console
- 6 - Tender container
- 7 - Bow and rear lifting eyes
- 8 - Bow plate with navigation lights
- 9 - Handles
- 10 - Tube hard end
- 11 - Rubbing strake
- 12 - Carrying handle
- 13 - Towing bow eye

Fig.4

STEERING CONSOLE.

Steering Console for DeLuxe and Tender Deluxe Versions.

Steering console Tender Luxe is intended for mounting steering system and remote control system.

The console may be installed on the BRIG boats F300, F330 and F360 Deluxe and Tender Deluxe versions.

The Steering console consists of the following main components (Fig.5):

- console body, that comprises the overhead part (2), hinged with lower part (1).
- cushion (3);
- lock (4);
- wire type steering grommet (5).

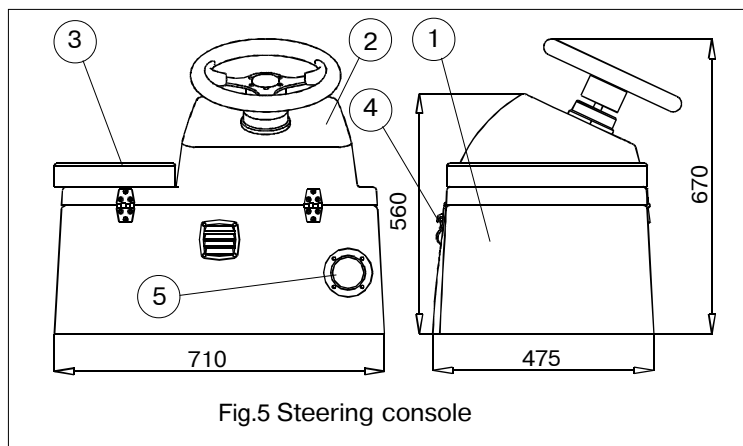

In order to install the console to the BRIG boat perform the next operations (Fig.6)

- hinge out the overhead console part;
- fix the console by means of the bolt M8x25 and washers to the deck boat;
- replace the console overhead part;

You can use inside compartment of the console as locker. Also you can dispose fuel tank (25L max) inside console (Fig.7). In this case you must fixed safely fuel tank by belt.

If you need less height of console, you can reduce it. Hinge out the overhead console part and her height will be 485mm (Fig.7).

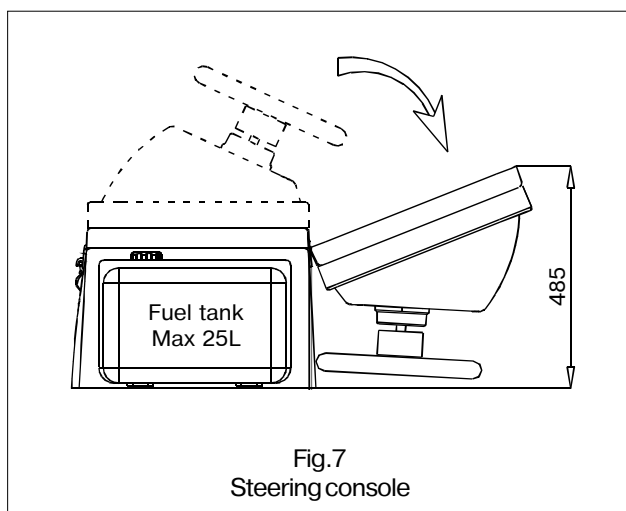
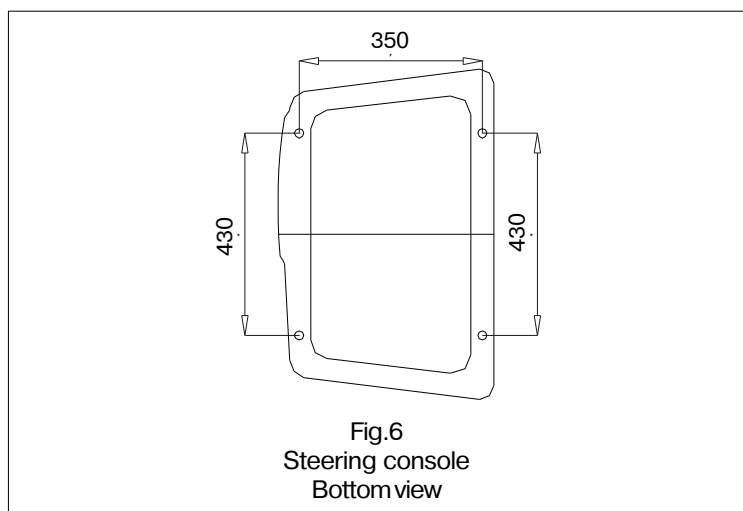

Tender Container for DeLuxe and Tender Deluxe Versions.

Tender Container is intended for placing of two passengers and for installation of storage battery, oars etc.

They may be mounted on the rigid deck of the "BRIG" boats F300, F330, F360 Deluxe and Tender Deluxe versions and other boats.

Tender Container includes: the locker, soft seat and lock to fixing the seat (see Fig.8).

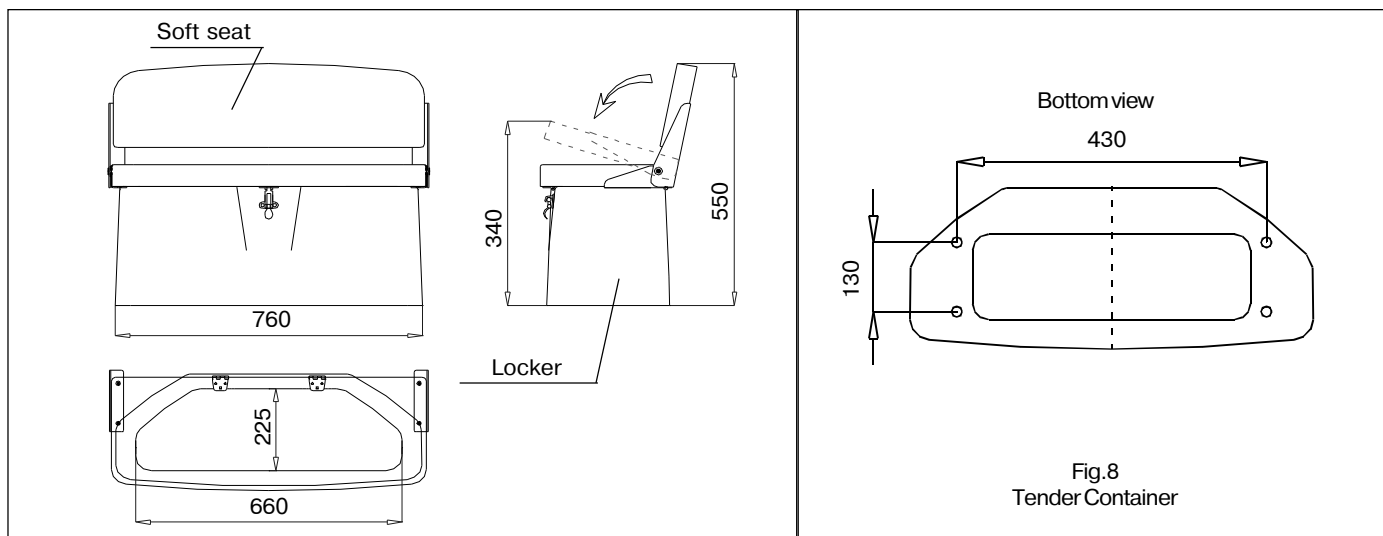

In order to install the container to the BRIG boat perform the next operations (see Fig. 8):

- hinge out the seat;
- fix the container by means of the bolt M8 and washers to the deck boat;
- replace the seat.

Steering Console for Sport Version.

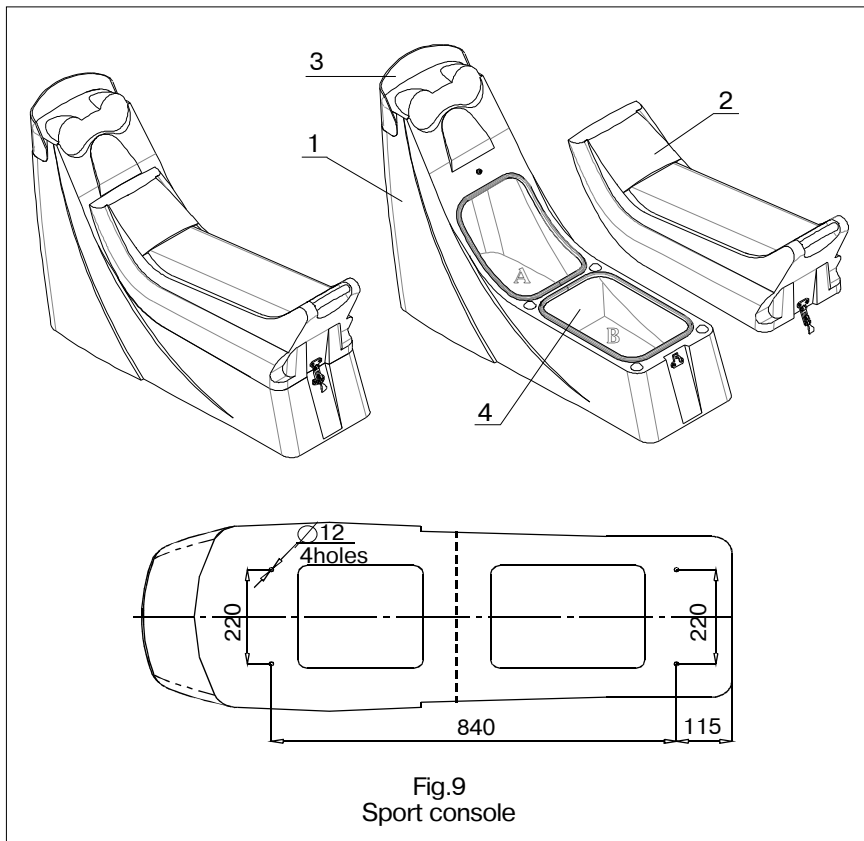

Console SPORT general view is shown in the Fig.9:

- 1.The console body.
- 2.The upper removable part with seat.
- 3.The windscreen.
- 4.The interior wall.

The interior wall divides the inner volume of the console body into two compartments. The compartment A is recommended for the installation of the storage battery, the compartment B has been designed for the installation of the standard fuel tank (12L max).

In order to install the console to the BRIG boat perform the next operations (Fig. 9):

- disconnect the upper removable part with seat;
- fix the console by means of the bolt M8 and washers to the deck boat;
- replace the upper removable part with seat.

Inflation/deflation boat tube.

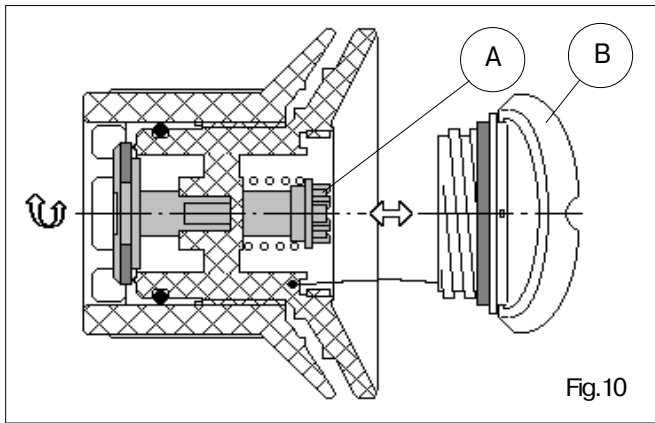

The inflation valve (see Fig. 10) has two positions of sliding part A corresponding to its two conditions (modes):

- sliding part A is withdrawn - operation condition of the valve (compartment air filling mode);
- sliding part A is recessed - valve in condition "OPEN" (compartment air discharge mode).

In order to switch the valve over from one condition to another, just press sliding part A with your finger to turn it by 90 degrees in any direction until it is fixed.

Prior to begin the compartment filling process set all valves in the operating condition. On completion of filling close the valves with bonnets B (rotate them clockwise).

In order to discharge air from the compartments, open the valves (by counterclockwise rotation) and switch the valves over into condition "OPEN".



Do not use compressors and/or other types of inflating equipments not approved by the boat builder.

Check tube pressure before every navigation.

The rated pressure value is 0.2 bar (2.9 psi).

If the tube pressure more than nominal, deflate the compartments slightly. Boat exploitation with board pressure more than nominal decreases boat service life.



Board air chambers are hermetical if they keep own form during 8 hours. In this case:

- primary pressure has to be nominal;
- input valves openings have to be tightly closed by caps.

PREPARATION FOR EXPLOITATION.

In order to set the boat in the operation condition perform as follows:

Unfold the inflatable balloon.

Apply the foot pump to fill the afterbody of the compartments with air to the pressure being slightly below its rated value (the balloon will be completely straightened). Then fill the forebody compartment with air up to the rated pressure.

The rated pressure value is 0.15 bar (2.2 pci).

On completion of filling close the valves with bonnets B (rotate them clockwise), (look before).

Assemble the oars by entering the removable parts with blades into the locks until the click. Make use of the holes provided in the oar handles to set the oars into the rowlocks with the blades being faced to the aft. Secure the oars in the holders.

When mounting the outboard engine make sure that it is reliably fixed to the transom. In addition, take every precaution to avoid any contacts of the fuel with the boat surfaces.

DRAIN SYSTEM.

1 - Drain valve for cockpit water
(see Fig.11)

2 - Drain valve for bilge water

It is dangerous to pretend to be an expert. This may cause damages. Refer to expert and authorized specialists for all types of maintenance and repair.



Check before navigation that that the drain valve for bilge water is closed by plug. Open to pour out the bilge water (! ashore ONLY !)

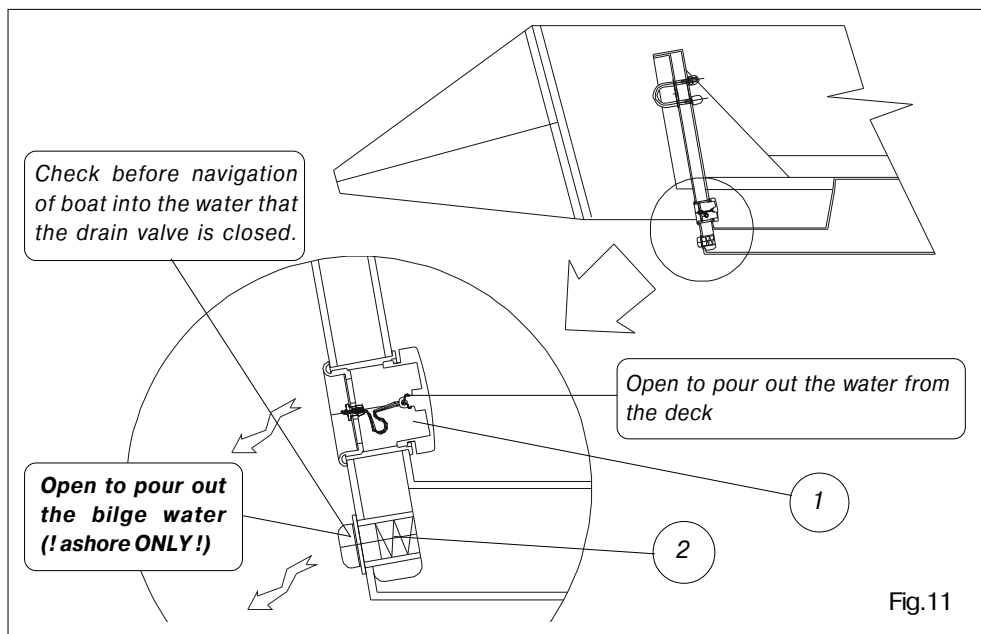
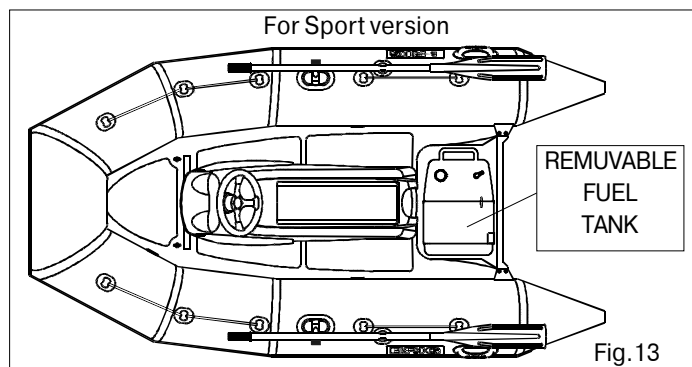
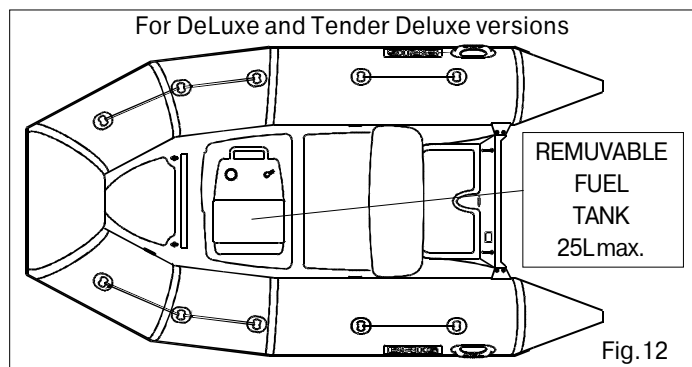

Fig.11

REMOVABLE FUEL TANK.

The recommended position on board for install of removable fuel tank is following:

- for DeLuxe and Tender Deluxe versions - inside the Tender console (fuel tank 25L max) (see Fig. 12)
- for Sport version - on the rear part of the boat (see. Fig. 13) or inside the Sport console.



Do not begin navigation without checking that the fixing of the fuel tank is tightened safely.



Check that there are no leaks in the fuel systems



Do not smoke when refueling. Stop the engine and switch off any electric equipments before refueling.

MAINTENANCE.

- Main conditions of long service life is right and careful servicing. Avoid excessive increasing of pressure in the board, especially from heating by the sun rays.
 - After exploitation take off sand and dirt from boat surface, and carefully dry it.
 - Avoid the water getting into the chambers. If a fuel or an oil gets to the boat surface it is necessary to wash the soiling place by soap water as soon as possible and dry.
 - Pay attention to the condition of bottom surfaces. If it's cover is destroyed it is necessary to dry this element and restore the defend cover.
 - After season prepare the boat to winter keeping. Clean boat surface from sand and dirt and make the necessary repairs, if damages take place. If it is possible, keep the boat in the open and slightly pumped state in air temperature 0-25°C. The boat must be protected from the sun rays.
 - Insignificant boat repairing (eliminating the board punctures or cuts) you may carry out by yourself. In this case use the coated fabric and glue set for repair from the complete set.
- Independent performance of any complex repair associated with considerable damages to the board, partitions and seams is not recommended. In such cases, apply to your dealer.

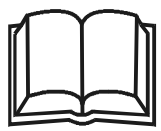

ATTENTION

Storage of the boat with temperature variations from -30°C to +45°C may be allowed for not longer than 1 month.

In case the boat has being stored or transported at a temperature bellow 0°C, it must be held at a temperature above +15°C for at least 1 hour before be unpacked and unfolded.

For small repair boat tube use the coated fabric and glue set from the complete set.

OPERATING REGULATIONS.

Dear user,





We thank your for your purchase and do hope that you will have a great fun of it. However, to make your joy and pleasure complete, we would request you to read carefully and observe the directions and recommendations specified below.







DANGER



IT IS STRICTLY FORBIDDEN to handle the boat in the state of intoxication and without individual rescue means being used (life-saving belts, jackets, etc.)

IT IS FORBIDDEN to use an outboard engine of power exceeding the maximum allowable value

 WARNING	IT IS FORBIDDEN to bring the tube pressure up to the value exceeding the rated one (0.15 bar(2.2pci))
	IT IS STRICTLY FORBIDDEN to drag the boat across a rough surface.
	For each particular water area the local shipping regulations are in force. You may apply for information to the appropriate water transport and shipping directorate, as well as to the water police.
 WARNING	Use the boat equipment and accessories only on their direct purpose to ensure reliable service.
	Even when sailing with an outboard engine you should always have the oars available with you so that you were able to reach the shore without outside assistance in case of any damage to the boat.
 WARNING	On your request any outboard engine seller may provide your engine with the emergency stop switch. During navigation the switch should be connected to the wrist of your hand by means of a cord. In case you fall overboard, even if being a steersman, the switch will cut out the engine and the propeller. This arrangement will enable you to avoid any traumas and to reach the boat.
	Take all possible precautions against penetration of fuel, oil or electrolyte from the storage battery into the inflatable boat. If it does happen wash thoroughly the fouled spots with water.
 DANGER	You should be always sure that the number of people on board never exceeds that specified in the owner's manual or on the builder's plate provided on the transom.
	The boat will retain an adequate floatability and will not keel over only provided that the load is arranged reasonably. Therefore, do not accommodate all passengers on the same side of the boat.
 DANGER	All passengers should be accommodated inside the boat. The occupied seats should not be left throughout the entire sailing time.

 DANGER	All passengers should put on life-saving jackets
	CHILDREN and non-swimmers MUST BE A FLOATATION DEVICE AT ALL TIMES.
	Always check that floatation devices for children are of the right size and that they are operational.
 DANGER	Arrange the cargo to be carried uniformly inside the boat, all items being reliably secured on the bottom of the boat.
	When sailing with an outboard engine the steersman should shift his body forward in the course of acceleration to prevent the boat forebody from raising under the force of upthrust waves.
 WARNING	Despite the strong shell of the boat we are recommended to handle sharp and pricking objects being on board with care. For example, it concerns a knife blade, fish-hook point, etc.
 DANGER	Approach rocky shores, shoals, moles, etc. carefully to avoid damages to the boat. It is strictly prohibited to drag the boat across rough surfaces (shingle, rocks, concrete, etc.).
	In case of prolonged navigation with the use of an outboard engine, regularly check to ensure that the engine is reliably attached to the boat. If the engine was attached carelessly the attachment may work loose under the action of vibration.
 WARNING	Besides, check air chambers pressure at regular intervals, since the pressure may vary under the effects of outside air temperature and atmospheric pressure variations.
	Never forget to monitor regularly the quantity of fuel in the fuel tank. Keep always in mind that the quantity of fuel should be sufficient for you to sail to your final destination.

● **Towing**

	<p>At towing the towing rope length should not be at least 3 lengths of the boat.</p> <p>The steersman of the towed boat should be assisted by another crew member to monitor the process of towing. In this case, certain communication gestures should be agreed upon beforehand.</p>
	<p>The rope being secured to both boats in a manner ensuring its immediately, single-motion release.</p>

● **Damage to one of air chambers**

The inflatable boat is designed to provide an adequate stability in case of the complete damage to one the air chambers (balloon compartments) at the expense of the remaining air chambers and the hull. Thanks to it, you will be able to reach safely the nearest shore. Reduce the speed and shift your body to the undamaged part of the boat. Watch changes in stability. After this immediately head for the nearest shore. To prevent penetration of water into the boat, pull the shell of the damaged air chambers upwards.

● **Anchor and mooring fast fastening**

	<p>Fix the anchor and towing ropes in the bow of the boat to the front towing ring. Fix the back anchor ropes to the back towing ring.</p>
---	--

● **Danger of currents and wind**

	<p>Before navigation of the boat make detail inquiries about local conditions and regulations! Currents, wind, shoals, rising and falling tides, as well as weather variations may imply serious danger!</p>
--	--

● **In emergency stay in boat**

In any unexpected situation (engine failure, boat damage, etc.) do not ever leave the boat provided it is still afloat. Even if you believe that the shore is just nearby stay in the boat, since you will be looked for in this particular place and, most probably, will be found. Should the boat become partially flooded throw heavy objects (batteries, fuel tank, engine) overboard to ensure additional floatability.

● **Handling under power**

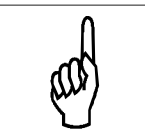
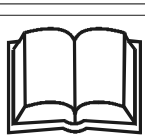
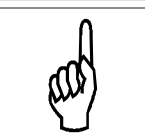
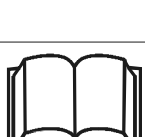
 WARNING	<p>Sudden turn may cause loss of control. Reduce speed before making sharp in either direction.</p>
 ATTENTION	<p>Maximum propulsion power rating for the boats:</p> <p>F330 - 18.3 kW (25 HP) F300 - 15 kW (20 HP) F360 - 25.7 kW (35 HP)</p> <p>When the boat is fitted with an engine with maximum recommended power it must be used with extreme care. This application is directed at experienced users using their boats for very specific purposes.</p>
 WARNING	<p>Do not operate your boat with an engine of rated power larger than that posted on the builder's plate in the boat.</p>
 ATTENTION	<p>Do not operate this craft at negative propulsion unit trim settings (bow down) at high speed. Craft may lean over on side. Instability in turns may result. Use negative trim to accelerate to planing speed from displacement speed and at lower planing speeds in choppy water (applicable to craft equipped with propulsion unit power trim).</p> <p>Do not operate at maximum speed while in congested high traffic waterways or in weather and sea conditions of reduced visibility high winds or large waves. Reduce speed and wake as a courtesy and as a safety consideration to yourself and others. Observe and obey speed limit and no wake zones.</p> <p>Observe right-of-way as defined by Rules of the Road and required by COLREG.</p> <p>Always be certain to have sufficient distance to stop or manoeuvre if required to avoid collisions.</p>

●REBOARDING MEANS.

All persons on board should always be in life jackets.

Before starting the motor, make sure that the safety pin is used.

If you are in the water, you can return on board.

To do this, there are handles (Fig.1 (12), (4)) on the boat tube that you can use to get back on board.

Boats of this model have a low freeboard.

The manufacturer does not complete the boat of this model with other reboarding means.

However, you can additionally order from your dealer other means to return on board.

Contact your dealer if necessary.

●WARNING SIGNS AND LABELS.

In accordance with ABYC standards, warning signs and labels are installed on your boat (if applicable).
Do not remove warning signs and labels. Always check their suitability.
If the warning signs are damaged and you cannot read the text or symbols, you must order new ones from your dealer.
Check with your dealer for the correct warning signs and labels mounting location.

BOAT CAPACITY LABEL.

Place of installation: on a boat transom

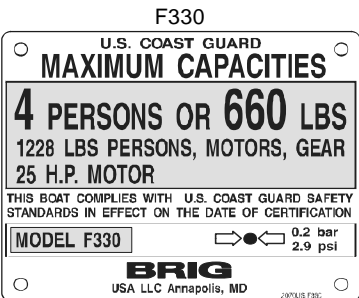

WARNING.MAXIMUM ENGINE WEIGHT.

Place of installation: on the hull of the boat near the outboard engine.

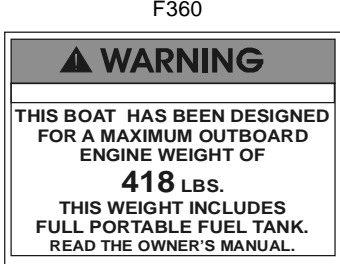
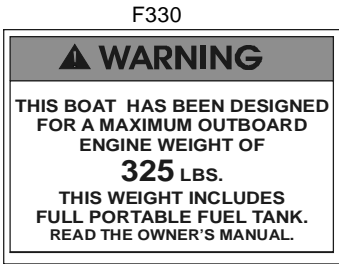
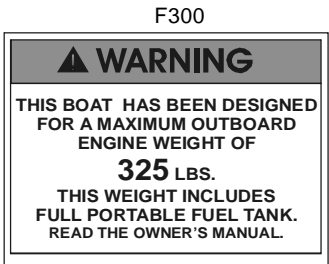

All models.

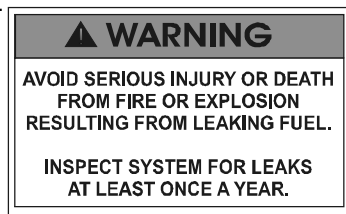

All models.

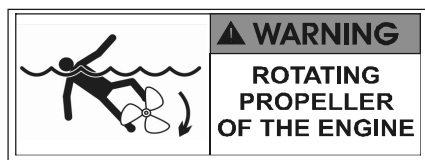

All models.

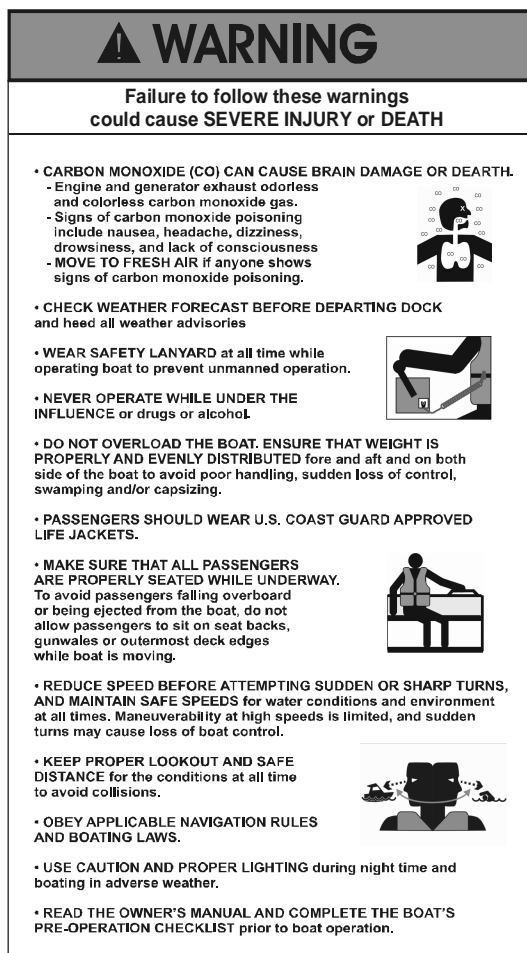

NOTE: The inflatable boat was delivered with the following equipment installed:

1.Fuel tank	Stamp and signature	NOTES
2.Electric system	Stamp and signature	NOTES
3.Drain system	Stamp and signature	NOTES
4.Steering system	Stamp and signature	NOTES
5.Engine power system	Stamp and signature	NOTES
6.Engine installation, test and completion of plants and fittings done by.	Stamp and signature	NOTES



MODEL

SERIAL No.

UA-QRK

Date of manufacture

Quality inspection stamp